

17061

AIRPORT DIAGRAM

CENTRAL IL RGNL ARPT AT BLOOMINGTON-NORMAL (B.M.I)
AL-5058 (FAA)
BLOOMINGTON, ILLINOIS

ATIS
135.35
BLOOMINGTON TOWER *
124.6 269.575
GND CON
121.65

D

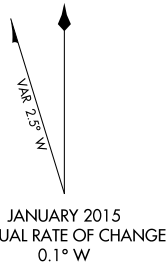

EC-3, 02 MAR 2017 to 30 MAR 2017

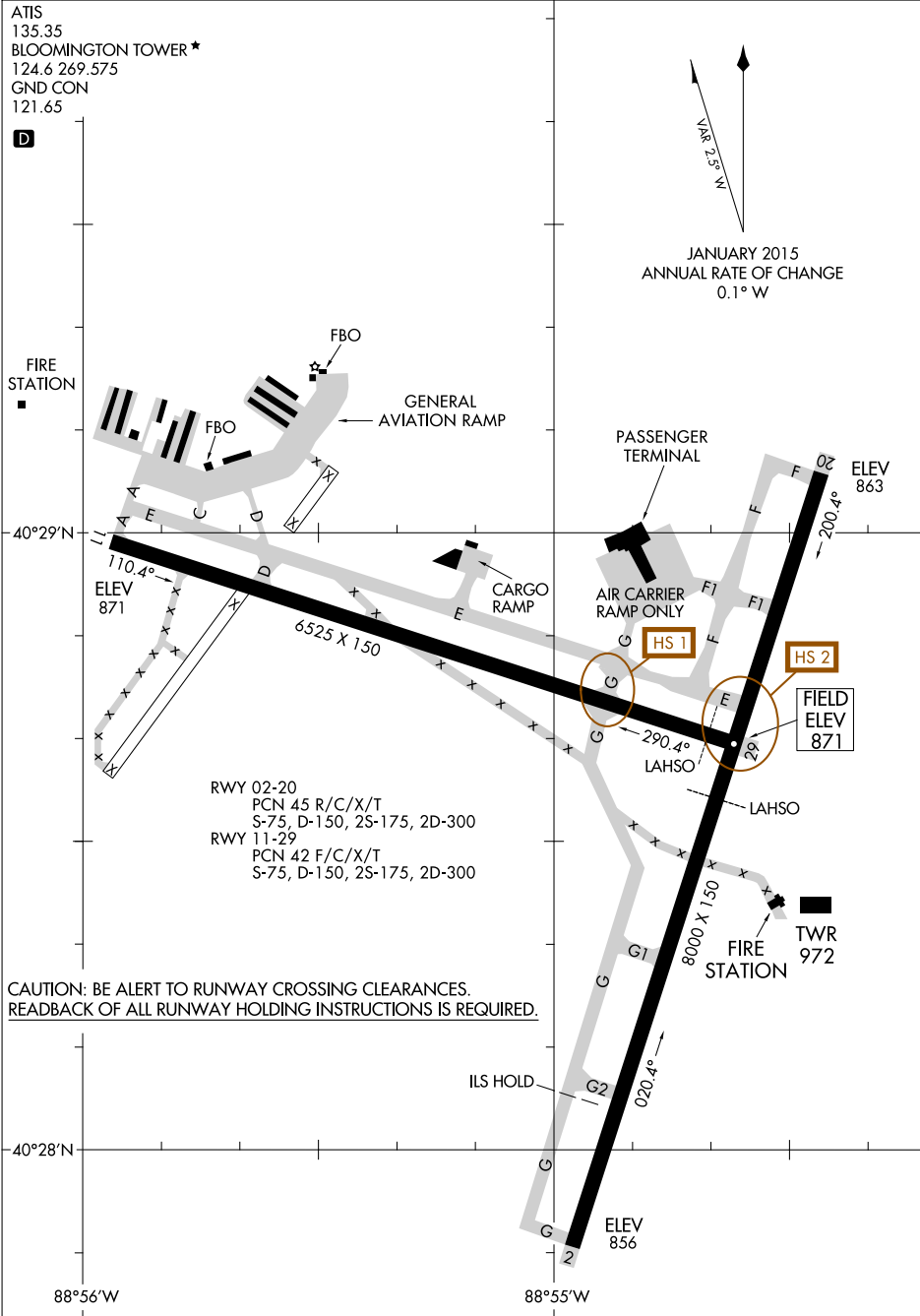

CAUTION: BE ALERT TO RUNWAY CROSSING CLEARANCES.
READBACK OF ALL RUNWAY HOLDING INSTRUCTIONS IS REQUIRED.

EC-3, 02 MAR 2017 to 30 MAR 2017

AIRPORT DIAGRAM

17061

BLOOMINGTON, ILLINOIS
CENTRAL IL RGNL ARPT AT BLOOMINGTON-NORMAL (B.M.I)