

**CAUTION: BE ALERT TO RUNWAY CROSSING CLEARANCES  
 READBACK OF ALL RUNWAY HOLDING INSTRUCTIONS IS REQUIRED.**

NOTE: Due to distance of tower from transient ramp,  
 ATC unable to provide visual guidance or positioning  
 of aircraft. USE CAUTION.

ATIS  
 133.15  
 FLINT TOWER \*  
 126.3 257.9  
 GND CON  
 121.9  
 CLNC DEL  
 121.75

JANUARY 2025  
 ANNUAL RATE OF CHANGE  
 0.0° W

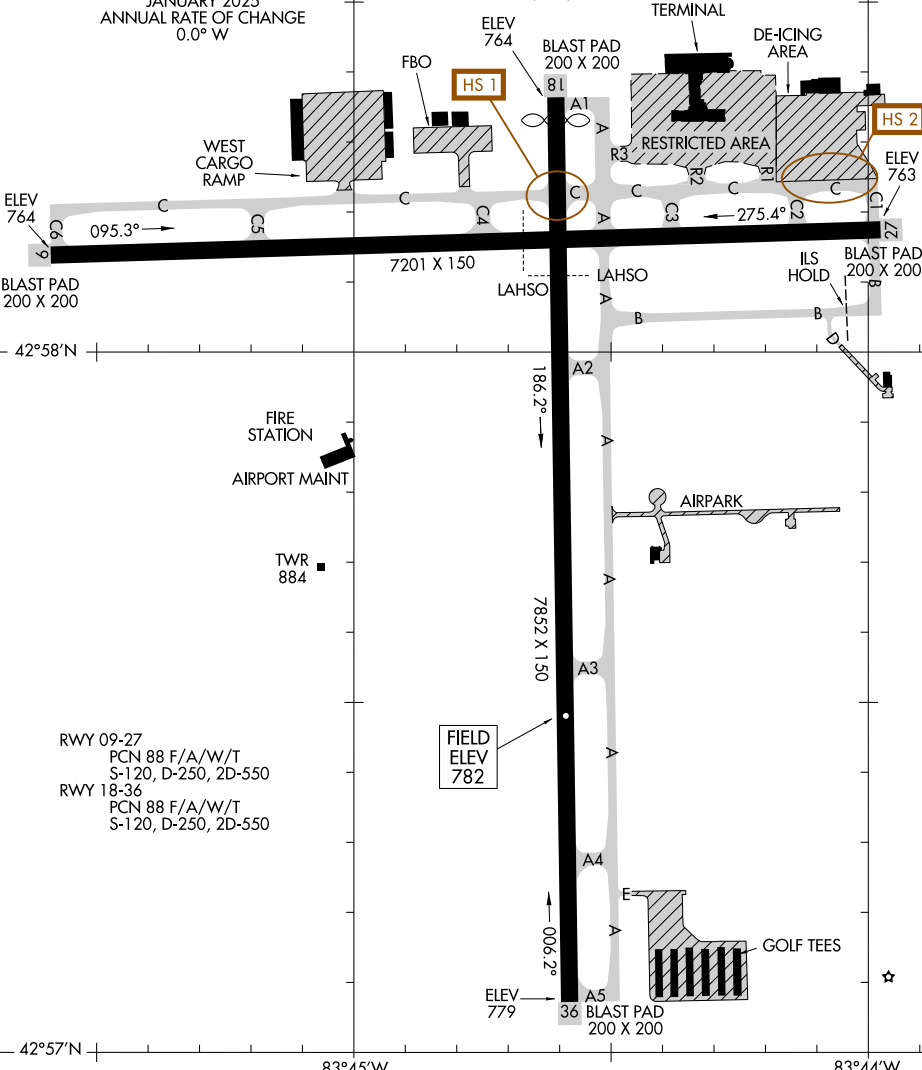

EC-1, 27 NOV 2025 to 25 DEC 2025

EC-1, 27 NOV 2025 to 25 DEC 2025