

AERODROME
CHART - ICAO

36°42'59"N
127°29'57"E

ELEV 192 ft

TWR 118.7 126.2
GND 121.875

CHEONGJU / Cheongju INTL

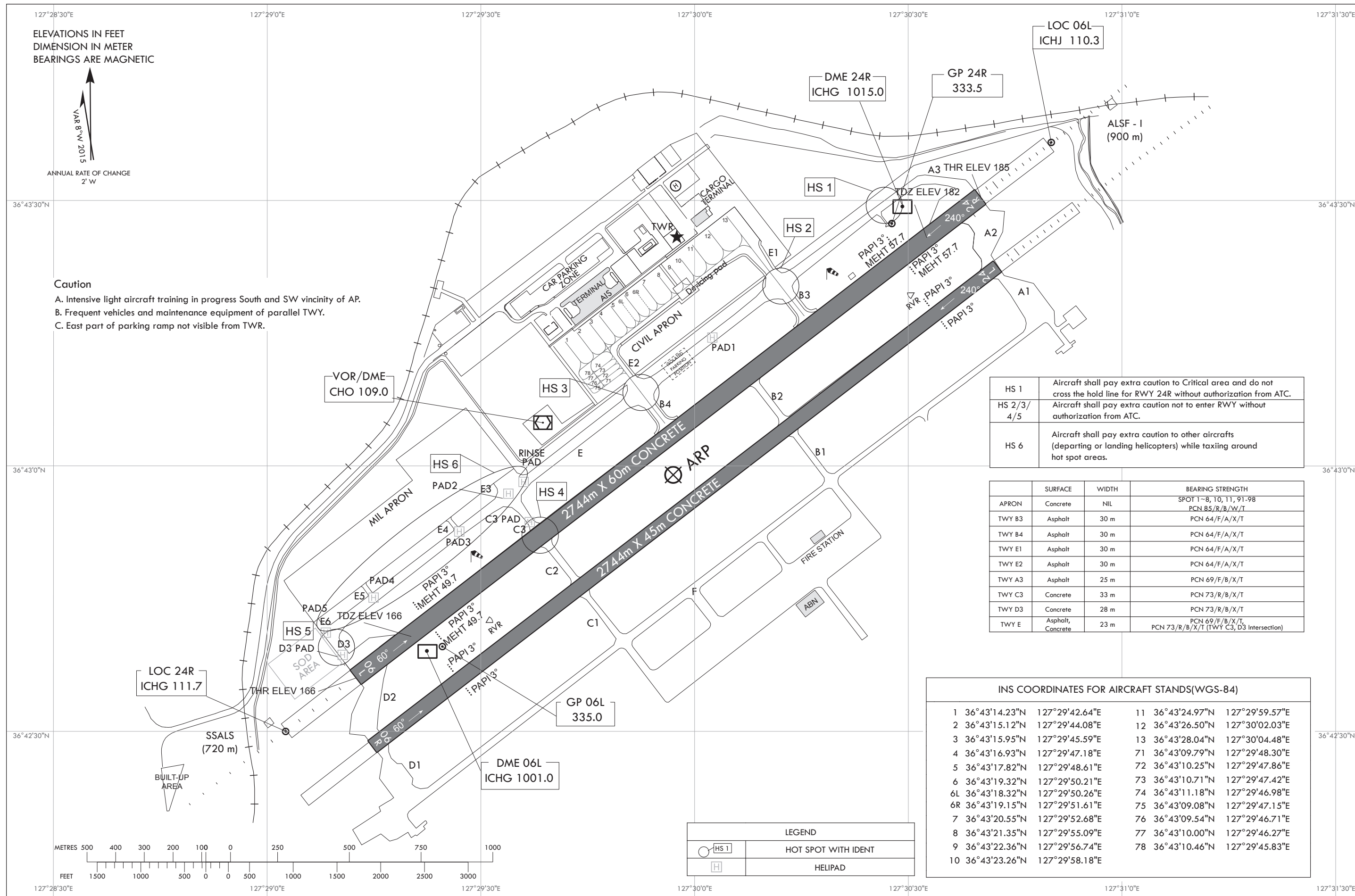

ELEVATIONS IN FEET
DIMENSION IN METER
BEARINGS ARE MAGNETIC

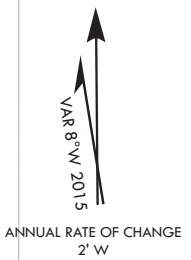

Caution
A. Intensive light aircraft training in progress South and SW vicinity of AP.
B. Frequent vehicles and maintenance equipment of parallel TWY.
C. East part of parking ramp not visible from TWR.

HS 1	Aircraft shall pay extra caution to Critical area and do not cross the hold line for RWY 24R without authorization from ATC.
HS 2/3/4/5	Aircraft shall pay extra caution not to enter RWY without authorization from ATC.
HS 6	Aircraft shall pay extra caution to other aircrafts (departing or landing helicopters) while taxiing around hot spot areas.

	SURFACE	WIDTH	BEARING STRENGTH
APRON	Concrete	NIL	SPOT 1-8, 10, 11, 91-98 PCN 85/R/B/W/T
TWY B3	Asphalt	30 m	PCN 64/F/A/X/T
TWY B4	Asphalt	30 m	PCN 64/F/A/X/T
TWY E1	Asphalt	30 m	PCN 64/F/A/X/T
TWY E2	Asphalt	30 m	PCN 64/F/A/X/T
TWY A3	Asphalt	25 m	PCN 69/F/B/X/T
TWY C3	Concrete	33 m	PCN 73/R/B/X/T
TWY D3	Concrete	28 m	PCN 73/R/B/X/T
TWY E	Asphalt, Concrete	23 m	PCN 69/F/B/X/T, PCN 73/R/B/X/T (TWY C3, D3 Intersection)

1	36°43'14.23"N	127°29'42.64"E	11	36°43'24.97"N	127°29'59.57"E
2	36°43'15.12"N	127°29'44.08"E	12	36°43'26.50"N	127°30'02.03"E
3	36°43'15.95"N	127°29'45.59"E	13	36°43'28.04"N	127°30'04.48"E
4	36°43'16.93"N	127°29'47.18"E	71	36°43'09.79"N	127°29'48.30"E
5	36°43'17.82"N	127°29'48.61"E	72	36°43'10.25"N	127°29'47.86"E
6	36°43'19.32"N	127°29'50.21"E	73	36°43'10.71"N	127°29'47.42"E
6L	36°43'18.32"N	127°29'50.26"E	74	36°43'11.18"N	127°29'46.98"E
6R	36°43'19.15"N	127°29'51.61"E	75	36°43'09.08"N	127°29'47.15"E
7	36°43'20.55"N	127°29'52.68"E	76	36°43'09.54"N	127°29'46.71"E
8	36°43'21.35"N	127°29'55.09"E	77	36°43'10.00"N	127°29'46.27"E
9	36°43'22.36"N	127°29'56.74"E	78	36°43'10.46"N	127°29'45.83"E
10	36°43'23.26"N	127°29'58.18"E			

	HS 1	HOT SPOT WITH IDENT
	H	HELIPAD

Change : Information of ACFT stands(NR. 1~8, 10, 11, 91~98 → NR. 1~13, 71~78).

MARKING AIDS RWY 06L/24R AND 06R/24L AND EXIT TWY

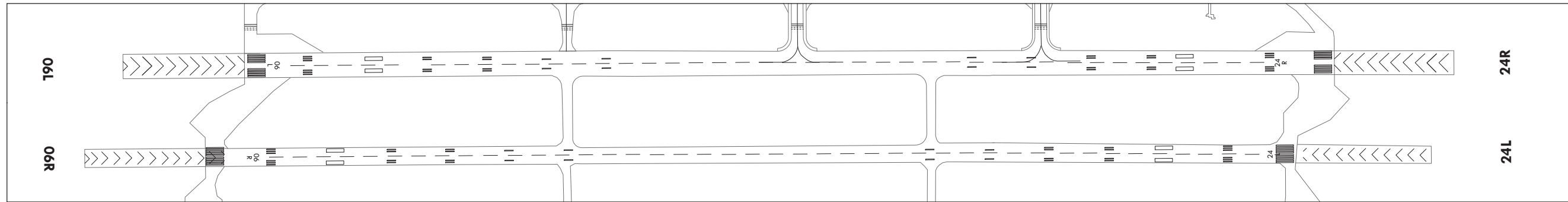

LIGHTING AIDS RWY 06L/24R AND 06R/24L AND EXIT TWY

